

SERIES TT 3 POINT LIFT

**PARTS
AND
OPERATER
MANUAL**

**TRI-TILL
THREE-IN-ONE
FIELD
CULTIVATOR
FOR
VINEYARD
AND
ORCHARDS**

**Domries Enterprises, Inc
12281 Rd 29**

Madera, California 93638

Phone (559) 673-9143

Fax (559) 673-4110

Visit our Web -Site at www.domriesentinc.com

IMPORTANT! PLEASE READ!

TO OUR CUSTOMER – USER’S RESPONSIBILITY – WARRANTY

TO OUR CUSTOMER

The following pages and illustrations are printed to help supply you with the knowledge to better operate and service your new **DOMRIES** equipment.

We are proud to have you as a customer and feel you will be proud to be a **DOMRIES** owner.

Any piece of equipment needs, and must have a certain amount of service and maintenance to keep it in top running condition. We have attempted to cover all the adjustments required to fit most conditions; however, there may be times special care must be taken to fit a condition.

Study this operator’s manual carefully and become acquainted with all the adjustments and operating procedures before attempting to operate your new equipment. Remember, it is a machine and has been designed and tested to do an efficient job in most operating conditions and will perform in relation to the service it receives.

If special attention is required for some conditions, ask your **DOMRIES** dealer; his Parts and Service Organization will be glad to help and answer any question on operation and service of your new machine.

ATTENTION! BECOME ALERT!

YOUR SAFETY IS INVOLVED

This symbol is used to call your attention to safety precautions that should be followed by the operator to avoid accidents. When you see this symbol – Heed Its Warning.

USER’S RESPONSIBILITY

It is the responsibility of the user to read the Operator’s Manual and understand the safe and correct operating procedures as pertains to the operation of the product, and to lubricate and maintain the product according to the maintenance schedule in the Operator’s Manual.

The user is responsible for inspecting his machine and for having parts repaired or replaced when continued use of the product would cause damage or excessive wear to other parts. It is the user’s responsibility to deliver his machine to a **DOMRIES** dealer, for service or replacement of defective parts which are covered by the standard warranty. When requesting warranty service, you present your copy of delivery record.

MODEL# _____

SERIAL# _____

ON HIGHWAY OPERATION

1. Use the **SLOW MOVING** vehicle emblem in daytime and approved warning lights at night, or during other periods of poor visibility, to prevent highway accidents.
2. **COMPLY** with Local highway regulation concerning moving machinery on highways.
3. **MAINTAIN** complete Control of machines at all times when traveling on the highway.
4. Due to the width of the implement, **US EXTRA CAUTION** on highways, far lanes and when approaching gates.

TT-1000

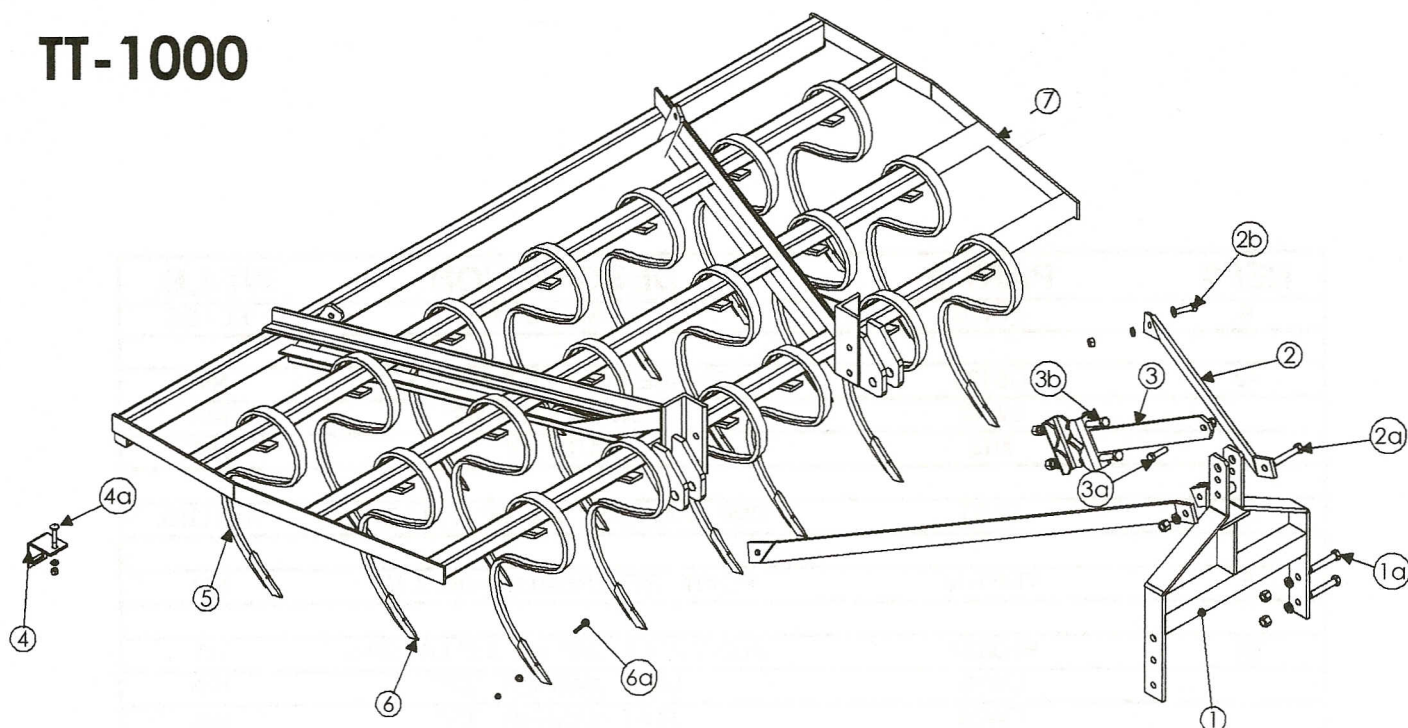

TRI-TILL MAIN FRAME & A-FRAME

REF#	PART #	DESCRIPTION	WT/LB.
1	TT-104	A FRAME TRI-TILL	55.0 LBS.
1a	CS345-5	BOLT - 3/4 X 4 LG. GR. 5	
	LW34	LOCK WASHER - 3/4"	
	N34	NUT - 3/4"	
2	TT-503	BRACE - A FRAME 5 FT.	18.0 LBS.
	TT-603	BRACE - A FRAME 6 FT.	
	TT-703L	BRACE - A FRAME L.H. 7 FT.- 9 FT.	
	TT-703R	BRACE - A FRAME R.H. 7 FT.- 9 FT.	
	TT-1003	BRACE - A FRAME R.H. 10 FT.- 14 FT.	20.5 LBS.
	TT-1004	BRACE - A FRAME L.H. 10 FT.- 14 FT.	
2a	CS345-5	BOLT - 3/4 X 4 LG. GR. 5	
	LW34	LOCK WASHER - 3/4"	
	N34	NUT - 3/4"	
2 b	CS582-5	BOLT - 5/8" X 2" LG. GR.5	
	LW58	LOCK WASHER - 5/8"	
	N58	NUT - 5/8"	
3	TT-104-S	CENTER BRACE W/ ACC-2 CLAMP(10'-14')	
3a	CS58212-5	BOLT - 5/8" X 2 1/2" LG. GR.5	
	LW58	LOCK WASHER - 5/8"	
	FW58	FLAT WASHER - 5/8"	
	N58	NUT - 5/8"	
3 b	CS347-5	BOLT-3/4" X 7" LG. GR. 5	
	LW34	LOCK WASHER 3/4"	
	N34	NUT 3/4"	

REF#	PART #	DESCRIPTION	WT/LB.
4	TT-705	CLAMP - S TINE	1.0 LBS
4a	CS124	CARRIAGE BOLT - 1/2" 4" LG. GR. 5	N/A
	LW12	LOCK WASHER 1/2"	N/A
	N12	NUT - 1/2"	N/A
5	TT-ST	S TINE SANIS (1/2" X 1 3/4" X 18 1/2" LG.)	10.5 LBS.
6	TT-PT-10	POINT - REVERSIBLE 6mm. X 1/4"	N/A
6a	PB382-5	PLOW BOLT - 3/8" NC. X 2" LG. GR-5	60
	LW12	LOCK WASHER - 3/8"	N/A
	FW38	FLAT WASHER - 3/8"	N/A
	N38	NUT - 3/8"	N/A
7	TT-308	MAIN FEAME - 3' 8"	N/A
	TT-400	MAIN FRAME - 4' 0"	N/A
	TT-500	MAIN FRAME - 5' 0"	N/A
	TT-600	MAIN FRAME - 6' 0"	N/A
	TT-700	MAIN FRAME - 7' 0"	N/A
	TT-800	MAIN FRAME - 8' 0"	N/A
	TT-900	MAIN FRAME - 9' 0"	N/A
	TT-1000	MAIN FRAME - 10' 0"	N/A
	TT-1200	MAIN FRAME - 12' 0"	N/A
	TT-1400	MAIN FRAME - 14' 0"	N/A

TT-M-500

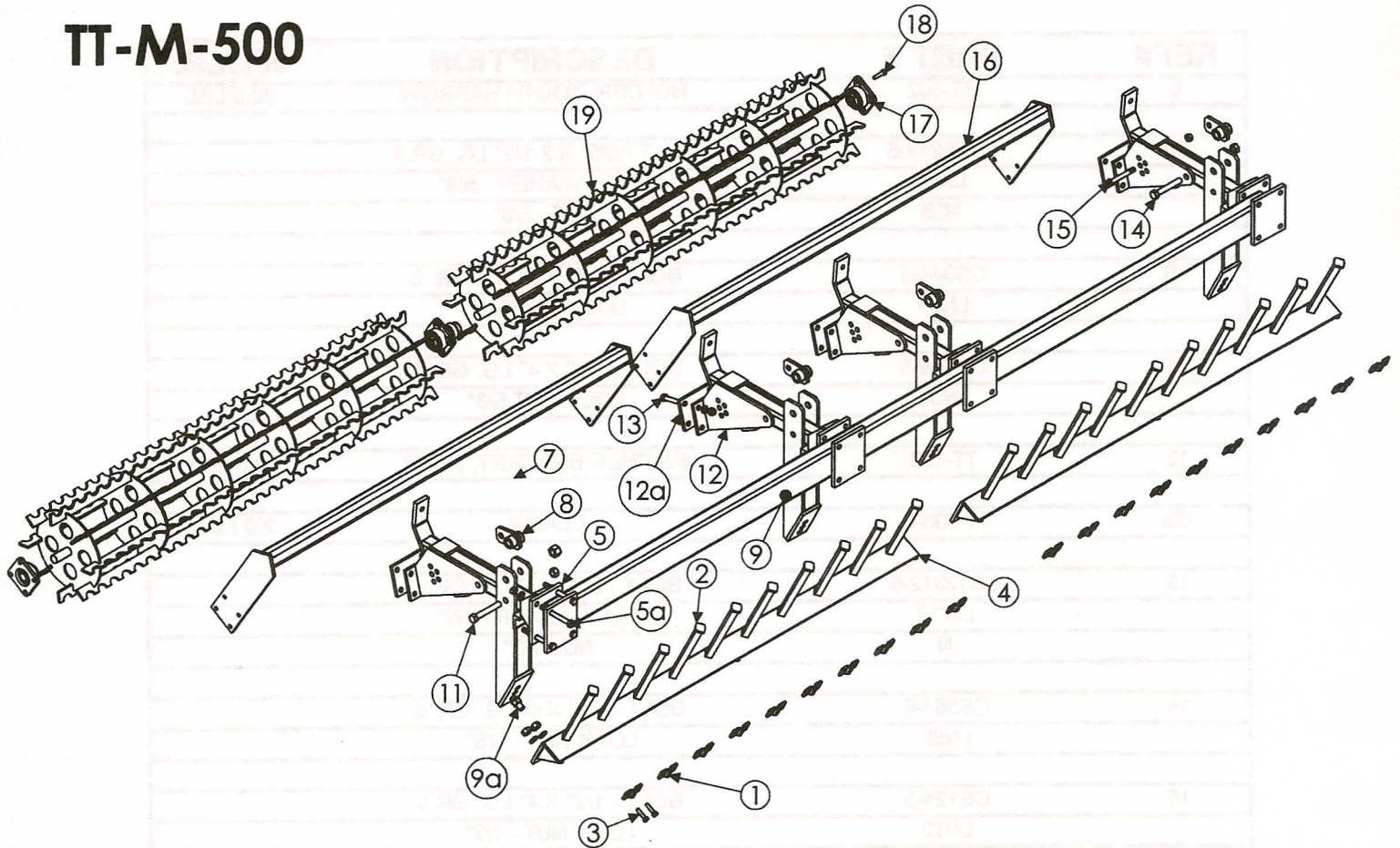

SPIKE AND MULCHER ASSEMBLY

REF#	PART #	DESCRIPTION	WT/LB.
1	CV-61	CLAMP - SPIKE	
2	TT-M-101	SPIKE, TOOTH HARROW	2.0 LBS
3	CS38112-5	BOLT - 3/8" X 1 1/2" LG. GR. 5	
	LW38	LOCK WASHER - 3/8"	
	N38	NUT - 3/8"	
4	TTH-308	SPIKE TOOTH HOLDER - 3' 8"	
	TTH-401	SPIKE TOOTH HOLDER - 4' 0"	
	TTH-501	SPIKE TOOTH HOLDER - 5' 0"	
	TT-505-01	SPIKE TOOTH HOLDER - 5' 5"	
	TT-601	SPIKE TOOTH HOLDER - 6' 0"	
	TT-606-01	SPIKE TOOTH HOLDER - 6' 6"	
	TT-609-01	SPIKE TOOTH HOLDER - 6' 9"	
	TT-701	SPIKE TOOTH HOLDER - 7' 0"	
	TT-801	SPIKE TOOTH HOLDER - 8' 0"	
	TT-807-01	SPIKE TOOTH HOLDER - 8' 7"	
5	TT-101	MULCHER BRACKET, FRONT	15.0 LBS.
5a	TT-101-C	CLAMP	
	CS124-5	BOLT - 1/2" X 4" LG. GR. 5	
	LW-12	LOCK WASHER - 1/2"	
	N1/2"	NUT - 1/2"	
6	TT-I-BOLT	JIG LATCH BOLT 1/2-13 X 4 5/16"	0.5 LBS.
	LN12	LOCK NUT - 1/2"	
7	TT-106	SPRING, TENSION - 5/16" X 10" LG.	3.5 LBS.
8	TT-105	SPACER	1.0 LBS.

REF#	PART #	DESCRIPTION	WT/LB.
9	TT-102	HOLDER, TOOTH HARROW	20.0 LBS.
9a	CS58212-5	BOLT - 5/8" X 2 1/2" LG. GR.5	
	LX58	LOCK WAHER - 5/8"	
	N58	NUT - 5/8"	
10	CS344-5	BOLT - 3/4" X 4" LG. GR. 5	
	LN34	LOCK NUT 3/4"	
11	CS584-5	BOLT - 5/8" X 4" LG. GR. 5	
	LN58	LOCK NUT-5/8"	
12	TT-103	MULCHER BRACKET, REAR	10.0 LBS.
12a	TT-103-C	CLAMP	2.0 LBS.
13	CS12312-5	BOLT - 5/8" X 4" LG. GR 5	
	LW12	LOCK WASHER - 1/2"	
	N	NUT-1/2"	
14	CS584-5	BOLT - 1/2" X 4" LG. GR. 5	
	LN58	LOCK NUT - 5/8"	
15	CS124-5	BOLT - 1/2" X 4" LG. GR.5	
	LN12	LOCK NUT - 1/2"	
16	TT-MF-308	MULCHER FRAME 3' 8"	N/A
	TT-404	MULCHER FRAME 4' 0"	25.0 LBS.
	TT-504	MULCHER FRAME 5' 0"	31.0 LBS.
	TT-505-04	MULCHER FRAME 5' 5"	34.0 LBS.
	TT-604	MULCHER FRAME 6' 0"	37.0 LBS.
	TT-606-04	MULCHER FRAME 6' 6"	41.0 LBS.
	TT-609-04	MULCHER FRAME 6' 9"	43.0 LBS.
	TT-704	MULCHER FRAME 7' 0"	44.0 LBS.
	TT-804	MULCHER FRAME 8' 0"	50.0 LBS.
	TT-807-04	MULCHER FRAME 8' 7"	54.0 LBS.
17	TT-205	BEARING (4) BOLT FLANGETTE	3.05 LBS.
18	CS38112-5	BOLT - 3/8" X 1 1/2" LG. GR. 5	
	LW38	LOCK WASHER -3/8"	
	N	NUT - 3/8"	
19	TTR-308	MULCHER ROLLER 3' 8"	N/A
	TTR-400	MULCHER ROLLER 4' 0"	61.0 LBS
	TTR-500	MULCHER ROLLER 5' 0"	76.0 LBS
	TTR-505	MULCHER ROLLER 5' 5"	83.0 LBS.
	TTR-600	MULCHER ROLLER 6' 0"	91.0 LBS.
	TTR-606	MULCHER ROLLER 6' 6"	100.0 LBS.
	TTR-609	MULCHER ROLLER 6' 9"	106.0 LBS.
	TTR-700	MULCHER ROLLER 7' 0"	109.0 LBS.
	TTR-800	MULCHER ROLLER 8' 0"	121.0 LBS.
	TTR-807	MULCHER ROLLER 8' 7"	132.0 LBS.

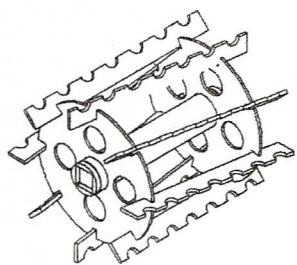

TTR-100

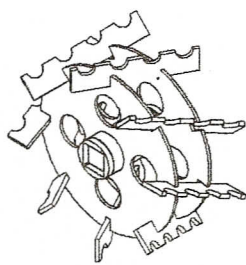

TTR-101

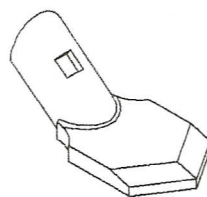

TT-PT-11

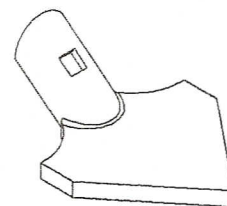

TT-PT-12

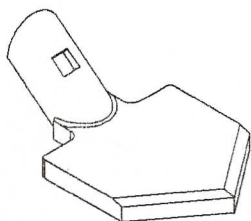

TT-PT-12DF

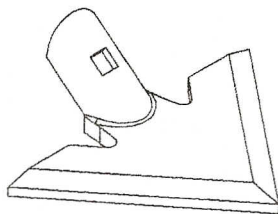

TT-PT-13

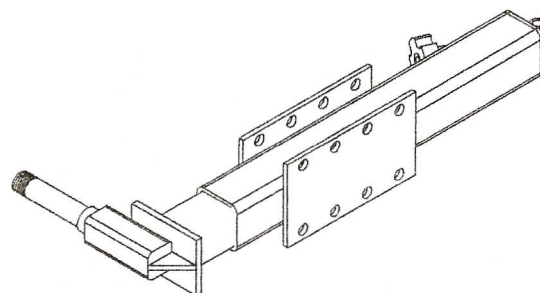

GAUGE WHEEL

OPTIONAL ATTACHMENTS

REF#	PART #	DESCRIPTION	WT/LB.
1	TTR-100	MULCHER, 14 3/4" LG.	21.25 LBS
2	TTR-101	MULCHER, 7 3/8" LG.	14.2 LBS.
3	TT-PT-11	POINT GOOSEFOOT SWEEP 2 3/4" X 6 mm. X 1/4"	0.5 LBS.
4	TT-PT-11DF	POINT GOOSEFOOT SWEEP 2 3/4" X 6 mm. X 1/4" (DURA-FACE)	1.0 LBS.
5	TT-PT-12	POINT - 4" SWEEP 6mm. X 1/4"	0.7 LBS.
6	TT-PT-12DF	POINT - 4" SWEEP 6mm. X 1/4" (DURA - FACE)	
7	TT-PT-13	POINT 7" SWEEP 6mm. X 1/4"	1.0 LBS.
8	TT-PT-13DF	POINT 7" SWEEP 6mm. X 1/4" (DURA - FACE)	1.4 LBS.
9	GAUGE WHEEL		

TT-1000

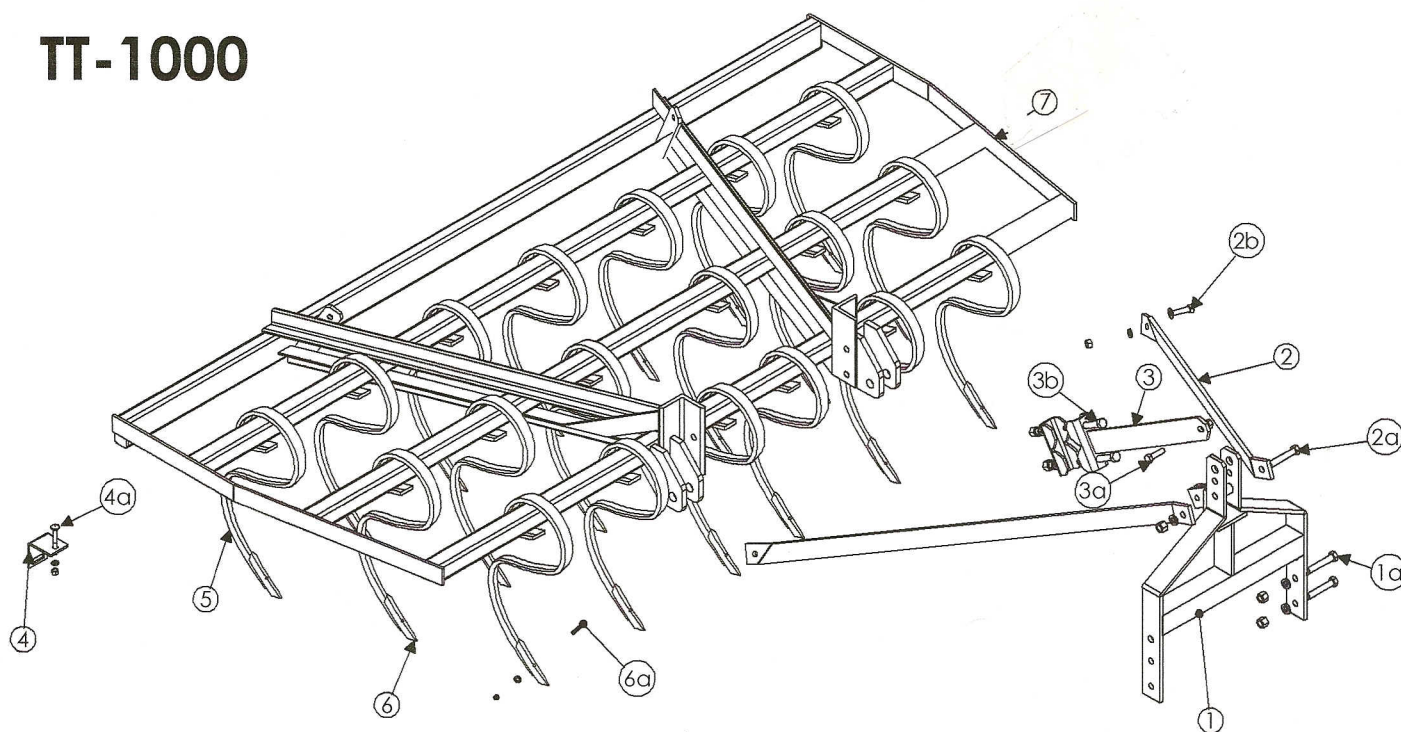

TRI-TILL MAIN FRAME & A-FRAME

REF#	PART #	DESCRIPTION	WT/LB.
1	TT-104	A FRAME TRI-TILL	55.0 LBS.
1a	CS345-5	BOLT - 3/4 X 4 LG. GR. 5	
	LW34	LOCK WASHER - 3/4"	
	N34	NUT - 3/4"	
2	TT-503	BRACE - A FRAME 5 FT.	18.0 LBS.
	TT-603	BRACE - A FRAME 6 FT.	
	TT-703L	BRACE - A FRAME L.H. 7 FT.- 9 FT.	
	TT-703R	BRACE - A FRAME R.H. 7 FT.- 9 FT.	
	TT-1003	BRACE - A FRAME R.H. 10 FT.- 14 FT.	20.5 LBS.
	TT-1004	BRACE - A FRAME L.H. 10 FT.- 14 FT.	
2a	CS345-5	BOLT - 3/4 X 4 LG. GR. 5	
	LW34	LOCK WASHER - 3/4"	
	N34	NUT - 3/4"	
2 b	CS582-5	BOLT - 5/8" X 2" LG. GR.5	
	LW58	LOCK WASHER - 5/8"	
	N58	NUT - 5/8"	
3	TT-104-S	CENTER BRACE W/ ACC-2 CLAMP(10'-14')	
3a	CS58212-5	BOLT - 5/8" X 2 1/2" LG. GR.5	
	LW58	LOCK WASHER - 5/8"	
	FW58	FLAT WASHER - 5/8"	
	N58	NUT - 5/8"	
3 b	CS347-5	BOLT-3/4" X 7" LG. GR. 5	
	LW34	LOCK WASHER 3/4"	
	N34	NUT 3/4"	

REF#	PART #	DESCRIPTION	WT/LB.
4	TT-705	CLAMP - S TINE	1.0 LBS
4a	CS124	CARRIAGE BOLT - 1/2" 4" LG. GR. 5	N/A
	LW12	LOCK WASHER 1/2"	N/A
	N12	NUT - 1/2"	N/A
5	TT-ST	S TINE SANIS (1/2" X 1 3/4" X 18 1/2" LG.)	10.5 LBS.
6	TT-PT-10	POINT - REVERSIBLE 6mm. X 1/4"	N/A
6a	PB382-5	PLOW BOLT - 3/8" NC. X 2" LG. GR-5	60
	LW12	LOCK WASHER - 3/8"	N/A
	FW38	FLAT WASHER - 3/8"	N/A
	N38	NUT - 3/8"	N/A
7	TT-308	MAIN FEAME - 3" 8"	N/A
	TT-400	MAIN FRAME - 4" 0"	N/A
	TT-500	MAIN FRAME - 5" 0"	N/A
	TT-600	MAIN FRAME - 6' 0"	N/A
	TT-700	MAIN FRAME - 7' 0"	N/A
	TT-800	MAIN FRAME - 8' 0"	N/A
	TT-900	MAIN FRAME - 9' 0"	N/A
	TT-1000	MAIN FRAME - 10' 0"	N/A
	TT-1200	MAIN FRAME - 12' 0"	N/A
	TT-1400	MAIN FRAME - 14' 0"	N/A

TT-M-500

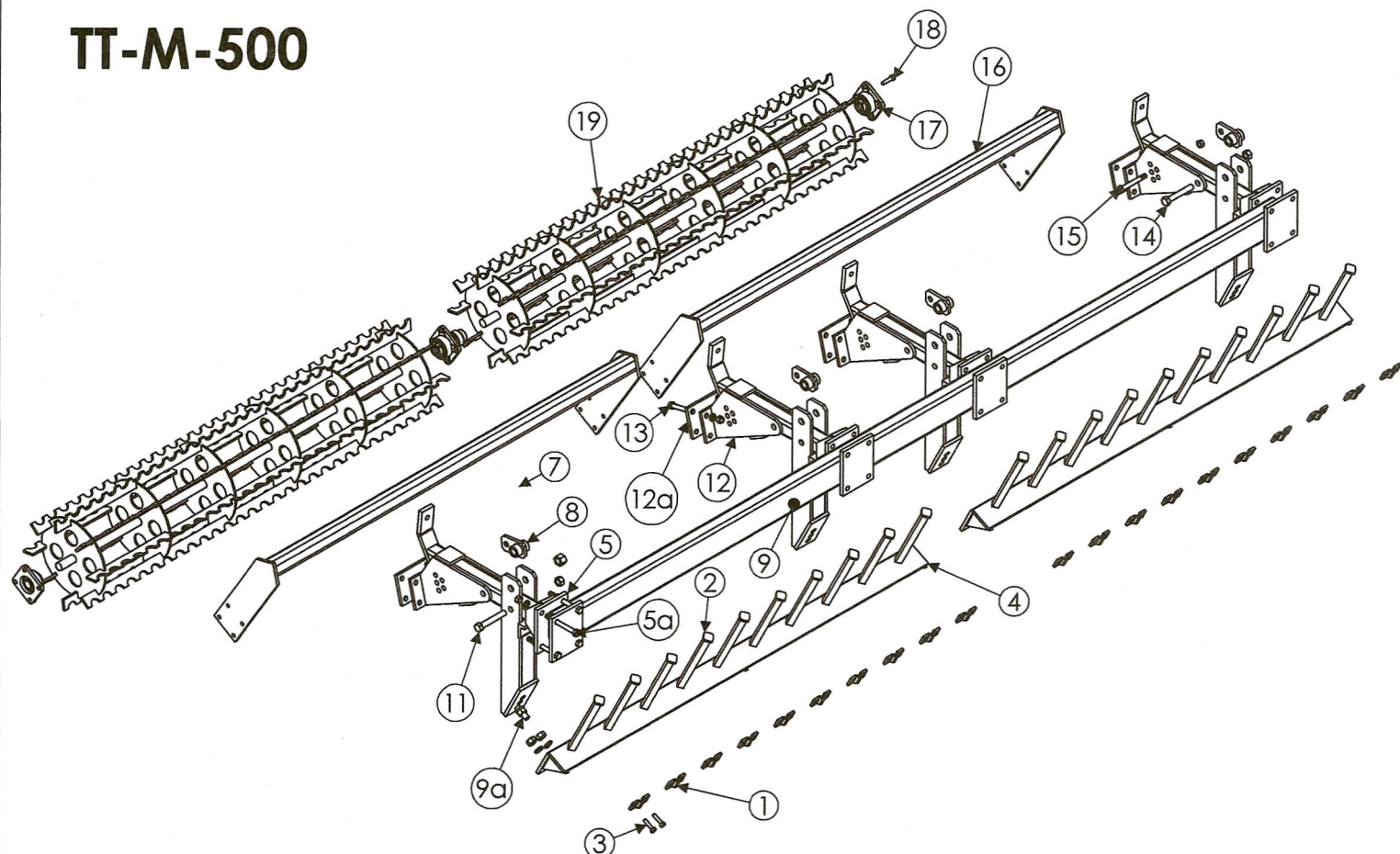

SPIKE AND MULCHER ASSEMBLY

REF#	PART #	DESCRIPTION	WT./LB.
1	CV-61	CLAMP - SPIKE	
2	TT-M-101	SPIKE, TOOTH HARROW	2.0 LBS
3	CS38112-5	BOLT - 3/8" X 1 1/2" LG. GR. 5	
	LW38	LOCK WASHER - 3/8"	
	N38	NUT - 3/8"	
4	TTH-308	SPIKE TOOTH HOLDER - 3' 8"	
	TTH-401	SPIKE TOOTH HOLDER - 4' 0"	
	TTH-501	SPIKE TOOTH HOLDER - 5' 0"	
	TT-505-01	SPIKE TOOTH HOLDER - 5' 5"	
	TT-601	SPIKE TOOTH HOLDER - 6' 0"	
	TT-606-01	SPIKE TOOTH HOLDER - 6' 6"	
	TT-609-01	SPIKE TOOTH HOLDER - 6' 9"	
	TT-701	SPIKE TOOTH HOLDER - 7' 0"	
	TT-801	SPIKE TOOTH HOLDER - 8' 0"	
	TT-807-01	SPIKE TOOTH HOLDER - 8' 7"	
5	TT-101	MULCHER BRACKET, FRONT	15.0 LBS.
5a	TT-101-C	CLAMP	
	CS124-5	BOLT - 1/2" X 4" LG. GR. 5	
	LW-12	LOCK WASHER - 1/2"	
	N1/2"	NUT - 1/2"	
6	TT-I-BOLT	JIG LATCH BOLT 1/2-13 X 4 5/16"	0.5 LBS.
	LN12	LOCK NUT - 1/2"	
7	TT-106	SPRING, TENSION - 5/16" X 10" LG.	3.5 LBS.
8	TT-105	SPACER	1.0 LBS.

REF#	PART #	DESCRIPTION	WT/LB.
9	TT-102	HOLDER, TOOTH HARROW	20.0 LBS.
9a	CS58212-5	BOLT - 5/8" X 2 1/2" LG. GR.5	
	LX58	LOCK WAHER - 5/8"	
	N58	NUT - 5/8"	
10	CS344-5	BOLT - 3/4" X 4" LG. GR. 5	
	LN34	LOCK NUT 3/4"	
11	CS584-5	BOLT - 5/8" X 4" LG. GR. 5	
	LN58	LOCK NUT-5/8"	
12	TT-103	MULCHER BRACKET, REAR	10.0 LBS.
12a	TT-103-C	CLAMP	2.0 LBS.
13	CS12312-5	BOLT - 5/8" X 4" LG. GR 5	
	LW12	LOCK WASHER - 1/2"	
	N	NUT-1/2"	
14	CS584-5	BOLT - 1/2" X 4" LG. GR. 5	
	LN58	LOCK NUT - 5/8"	
15	CS124-5	BOLT - 1/2" X 4" LG. GR.5	
	LN12	LOCK NUT - 1/2"	
16	TT-MF-308	MULCHER FRAME 3' 8"	N/A
	TT-404	MULCHER FRAME 4' 0"	25.0 LBS.
	TT-504	MULCHER FRAME 5' 0"	31.0 LBS.
	TT-505-04	MULCHER FRAME 5' 5"	34.0 LBS.
	TT-604	MULCHER FRAME 6' 0"	37.0 LBS.
	TT-606-04	MULCHER FRAME 6' 6"	41.0 LBS.
	TT-609-04	MULCHER FRAME 6' 9"	43.0 LBS.
	TT-704	MULCHER FRAME 7' 0"	44.0 LBS.
	TT-804	MULCHER FRAME 8' 0"	50.0 LBS.
	TT-807-04	MULCHER FRAME 8' 7"	54.0 LBS.
17	TT-205	BEARING (4) BOLT FLANGETTE	3.05 LBS.
18	CS38112-5	BOLT - 3/8" X 1 1/2" LG. GR. 5	
	LW38	LOCK WASHER -3/8"	
	N	NUT - 3/8"	
19	TTR-308	MULCHER ROLLER 3' 8"	N/A
	TTR-400	MULCHER ROLLER 4' 0"	61.0 LBS.
	TTR-500	MULCHER ROLLER 5' 0"	76.0 LBS.
	TTR-505	MULCHER ROLLER 5' 5"	83.0 LBS.
	TTR-600	MULCHER ROLLER 6' 0"	91.0 LBS.
	TTR-606	MULCHER ROLLER 6' 6"	100.0 LBS.
	TTR-609	MULCHER ROLLER 6' 9"	106.0 LBS.
	TTR-700	MULCHER ROLLER 7' 0"	109.0 LBS.
	TTR-800	MULCHER ROLLER 8' 0"	121.0 LBS.
	TTR-807	MULCHER ROLLER 8' 7"	132.0 LBS.

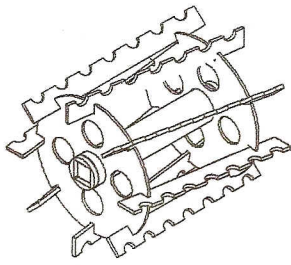

TTR-100

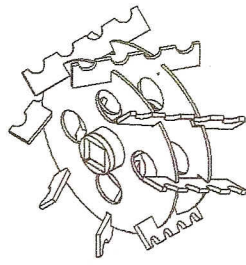

TTR-101

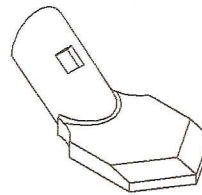

TT-PT-11

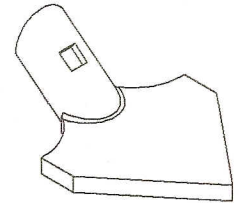

TT-PT-12

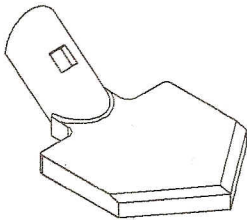

TT-PT-12DF

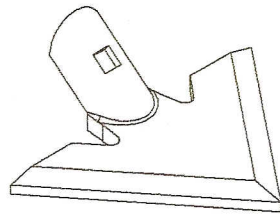

TT-PT-13

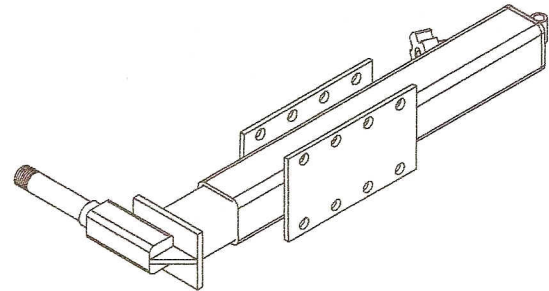

GAUGE WHEEL

OPTIONAL ATTACHMENTS

REF#	PART #	DESCRIPTION	WT/LB.
1	TTR-100	MULCHER, 14 3/4" LG.	21.25 LBS.
2	TTR-101	MULCHER, 7 3/8" LG.	14.2 LBS.
3	TT-PT-11	POINT GOOSEFOOT SWEEP 2 3/4" X 6 mm. X 1/4"	0.5 LBS.
4	TT-PT-11DF	POINT GOOSEFOOT SWEEP 2 3/4" X 6 mm. X 1/4" (DURA-FACE)	1.0 LBS.
5	TT-PT-12	POINT - 4" SWEEP 6mm. X 1/4"	0.7 LBS.
6	TT-PT-12DF	POINT - 4" SWEEP 6mm. X 1/4" (DURA - FACE)	
7	TT-PT-13	POINT 7" SWEEP 6mm. X 1/4"	1.0 LBS.
8	TT-PT-13DF	POINT 7" SWEEP 6mm. X 1/4" (DURA - FACE)	1.4 LBS.
9	GAUGE WHEEL		

DOMRIES ENTERPRISES, INC.

12281 Road 29
Madera, California 93637



Phone (559) 673-9143

FAX (559) 673-4110

www.domriesentinc.com

WARRANTY

Domries warrant's all products of it's manufacture to be free of defects in material and workmanship under normal usage and maintenance for the period of one year from the date of delivery to the original purchaser.

RETURN GOODS

Domries Shall have the option of requiring the prepaid return of any parts claimed defective, however, No parts shall be returned without Domries warranty form with goods authorized number. Goods shall be returned to such location as shall be designed by Domries.

Domries will, at it's option, either repair or replace, F.O.B. Domries factory. Such parts as appear to Domries upon inspection, to have been defective in materials and/or workmanship. Wearing parts that are determined to be defective are subject to an adjustment based upon useful life.

REPAIRS

Any field or repairs must have the authorized repair number from Domries before any work is done. Claim for warranty must be made with a Domries warranty form and repair number.

Domries will not accept any charged other then its direct Dealer shop labor costs and parts required to remedy such parts and/or workmanship at its Dealer place of business. The WARRANTY specifically excludes any charges for delivery, transportation, and/or shipping costs.

If the dealer is requested by the the customer to travel or haul the machine to his shop or repair shop for the purpose of performing a warranty obligation or free inspection, it would be for the customers convenience, and the cost of such a trip is to be paid by the Customer. Any arrangement whereby the Dealer agrees to absorb all or a part of the cost is to be made between the Dealer and the Customer. To be considered a courtesy to the Customer by their Dealer.

LIMITED WARRANTY

Outside purchased equipment and accessories (not of Domries manufacture) are warranted only to the extent of the original manufacture's warranty to Domries.

Items limited – Hydraulic cylinders and hose – Bearings – Disc Blades – Wheels – Tires – Tubes – Seals.

No warranty shall be paid by Domries before the part or parts and labor have been paid to Domries by the manufacturer. Domries shall then compensate the dealer or customer.

NO WARRANTY

(1) New product that has been subject to operation in excess in recommended capacities, misused, negligence, lack of maintenance or accident or have been altered or repaired in any manner not authorized by Domries.

(2) Sharp turns while machine is ground void warranty, with the exception of a drag disc.

Domries shall in no event be responsible for any delay or any other consequential or indirect damage in connection with fulfilling any obligation under this WARRANTY.

Domries reserves the right to make change at any time in designs, materials and/or specifications of it's product without becoming liable or obligated in any way to make similar changes in previously manufactured products.

This WARRANTY IS IN LIEU OF ALL OTHER WARRANTIES COVERING DOMRIES PRODUCTS and no other Warranties expressed or implied are made or authorized by Domries Enterprises, Inc.

This WARRANTY BECAME EFFECTIVE with shipments made on or after August 1st 1998