

SERIES MODEL TFO

**PARTS
&
OPERATOR
MANUAL**

**EXTRA
HEAVY
DUTY**

Domries Enterprises, Inc

12281 Road 29

Madera, California 93638

Phone (559) 673-9143 Fax (559) 673-4110

Visit our Web Site at WWW.domriesentinc.com

MODEL-TFO

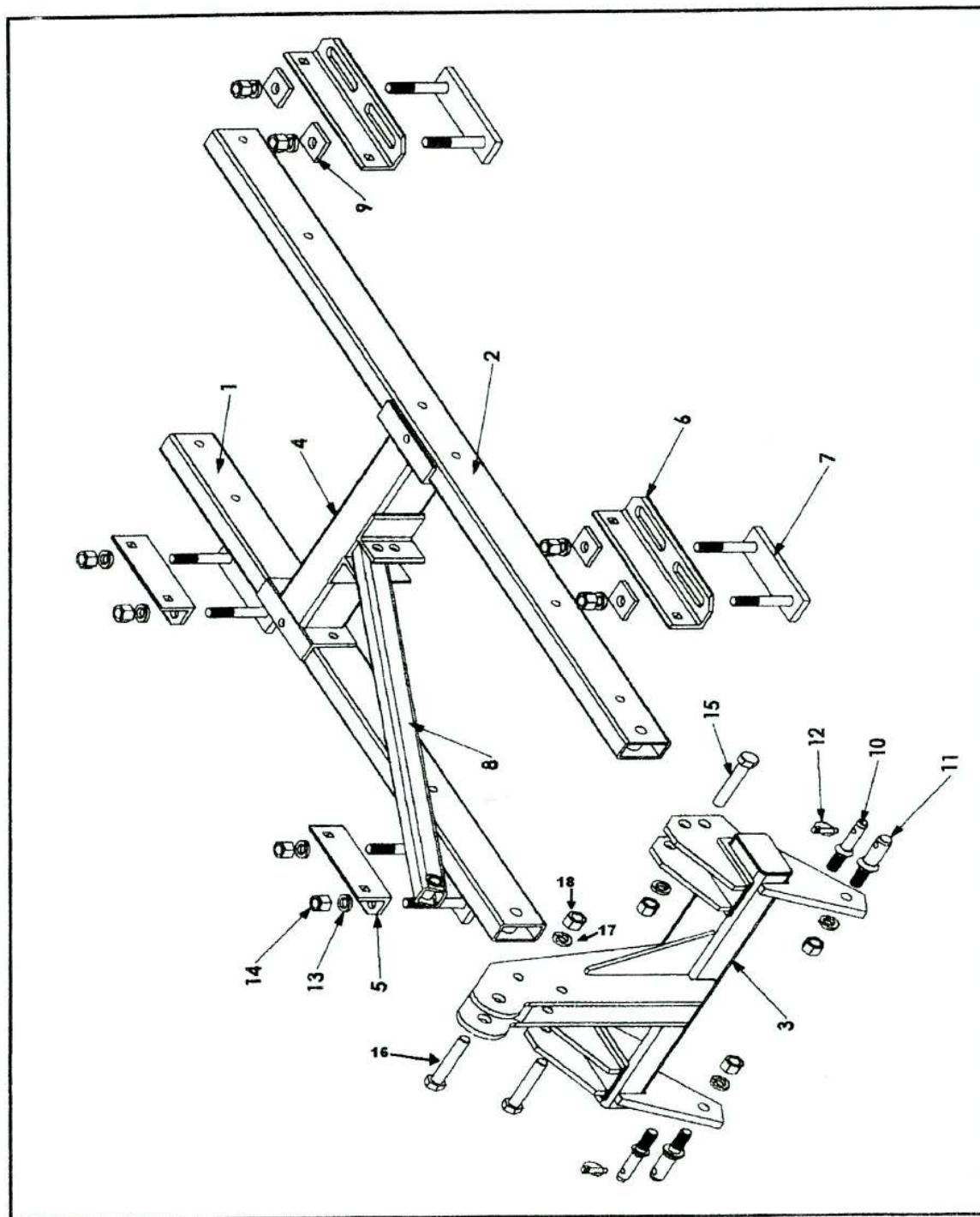

TFO - Main Gang Fram

MODEL-TFO

Ref#	Part#	Main Gang Frame	Wt./lb	List Price
1	FO-1-1	Slide Rail - RH, 14 & 16 blade	45.5	
	FO-1-2	Slide Rail - RH, 18 blade	47.7	
	FO-1-3	Slide Rail - RH, 20 blade	99.7	
	FO-1-4	Slide Rail - RH, 22 blade	103.9	
	FO-1-5	Slide Rail - RH, 24 blade	108.1	
2	FO-2-1	Slide Rail - LH, 14 & 16 blade	58.1	
	FO-2-2	Slide Rail - LH, 18 blade	58.1	
	FO-2-3	Slide Rail - LH, 20 blade	128	
	FO-2-4	Slide Rail - LH, 22 blade	132.2	
	FO-2-5	Slide Rail - LH, 24 blade	136.4	
3	FO-3-1	"A" Frame - Cat I (14, 16, & 18 blade)	126.3	
	FO-3-2	"A" Frame - Cat II (14, 16, & 18 blade)	126.2	
	FO-3-3	"A" Frame - Cat I (20, 22, & 24 blade)	126.3	
	FO-3-4	"A" Frame - Cat II (20, 22, & 24 blade)	126.2	
4	FO-4-1	Crossmember - 14, 16, & 18 blade	37.9	
	FO-4-2	Crossmember - 20, 22, & 24 blade	55.7	
5	FO-5	Angle Mnt - RH	4.5	
6	FO-6	Angle Mnt - LH	6.5	
7	FO-7	Clamp Plate	5.8	
8	FO-16	Brace - 'A' Frame (14, 16, & 18 blade)	22.6	
	FO-17	Brace - 'A' Frame (20, 22, & 24 blade)	23	
9	W1029C	Flat Washer Frame Bolt	0.2	
10	ALP-2	Lift Pin - Cat I, 7/8 x 6	0.5	
11	ALP-6	Lift Pin - Cat II, 1-1/8 x 6	1	
12	BLD33	Klick Pin, 7/16 dia	0.2	
13	LW78	Lockwasher, 7/8	0.1	
14	N78	Nut, 7/8	0.2	
15	CS78512-5	Capscrew, 7/8 x 5-1/2	2.2	
16	CS344-5	Capscrew, 3/4 x 4		
17	LW34	Lockwasher, 3/4		
18	N34	Nut, 3/4		

DOMRIES ENTERPRISES INC.

12281 Road 29

Madera, California 93638

Phone (559) 673-9143 Fax (559)673-4110

www.domrieseninc.com

MODEL-TFO

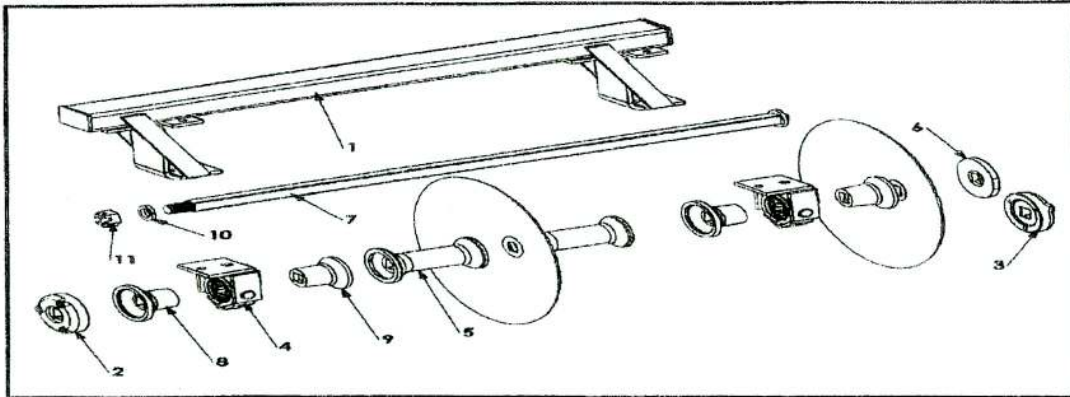

Ref#	Part#	Gang Frame Assembly	Wt./lb	List Price
1	FO-10-1	G. Frame - 7 blade	80	
	FO-10-2	G. Frame - 8 blade	93.5	
	FO-10-3	G. Frame - 9 blade	106	
	FO-10-4	G. Frame - 10 blade	118.5	
	FO-10-5	G. Frame - 11 blade	131.5	
2	JXE-18	Ext. Washer - CVX, 1-1/2sq	9	
3	JXE-19	Ext. Washer - CCV, 1-1/2sq	8	
4	X-80-A	Gng. Brg. Assy. - 1-1/2sq	17.3	
5	X-90	Full Spool, 1-1/2sq	12	
6	X-98	End Washer - Universal, 1-1/2sq	4.7	
7	XGR-5	Gang Rod - 1-1/2sq - 5 blade	26	
	XGR-6	Gang Rod - 1-1/2sq - 6 blade	32	
	XGR-7L	Gang Rod - 1-1/2sq - 7 blade	38.1	
	XGR-8L	Gang Rod - 1-1/2sq - 8 blade	44.1	
	XGR-9L	Gang Rod - 1-1/2sq - 9 blade	50.1	
	XGR-10L	Gang Rod - 1-1/2sq - 10 blade	56	
8	XJ-83	Half Spool - CCV, 1-1/2sq	6.5	
9	XJ-84	Half Spool - CVX, 1-1/2sq	5.7	
10	LW112	Lockwasher - Spring, 1-1/2sq	0.2	
11	SN112	Slotted Nut - 1-1/2nc, Hex	0.8	

DOMRIES ENTERPRISES INC.

12281 Road 29

Madera, California 93638

Phone (559) 673-9143 Fax (559)673-4110

www.domrieseninc.com

MODEL-TFO

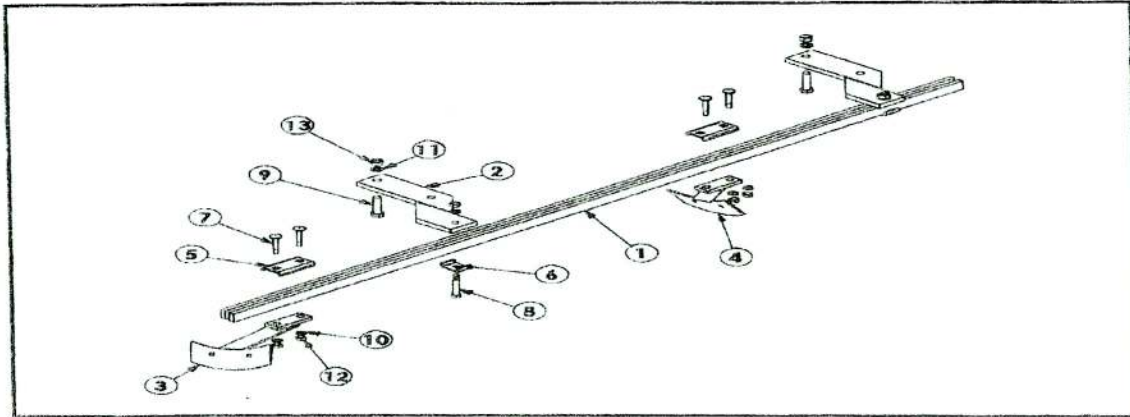

Ref#	Part#	Cleaner Bar Assembly	Wt./lb	List Price
1	FO-12-1	Cleaner Bar - 7 blade	30	
	FO-12-2	Cleaner Bar - 8 blade	34.4	
	FO-12-3	Cleaner Bar - 9 blade	38.3	
	FO-12-4	Cleaner Bar - 10 blade	43	
	FO-12-5	Cleaner Bar - 11 blade	46	
	FO-12-6	Cleaner Bar - 12 blade	49.9	
2	FO-12	Cleaner Bar Plate	8.5	
3	FO-13	Cleaner Arm Front	3.5	
4	FO-15	Cleaner Arm Rear	3.5	
5	WOC-110	Clamp-Cleaner Arm	0.5	
6	RPO-120	Clip-Scraper Arm	0.4	
7	CB123-5	Carriage Bolt - 1/2ncx 3 lg		
8	CS12312-5	Bolt - 1/2ncx3 1/2lg, GR5		
9	CS583-5	Bolt - 5/8ncx3lg, GR5		
10	LW12	Lock Washer Spring		
11	LW58	Lock Washer Spring		
12	N12	Nut - 1/2nx, Hex		
13	N58	Nut - 5/8nc, Hex		

DOMRIES ENTERPRISES INC.

12281 Road 29
Madera, California 93638
Phone (559) 673-9143 Fax (559)673-4110
www.domrieseninc.com

MODEL-TFO

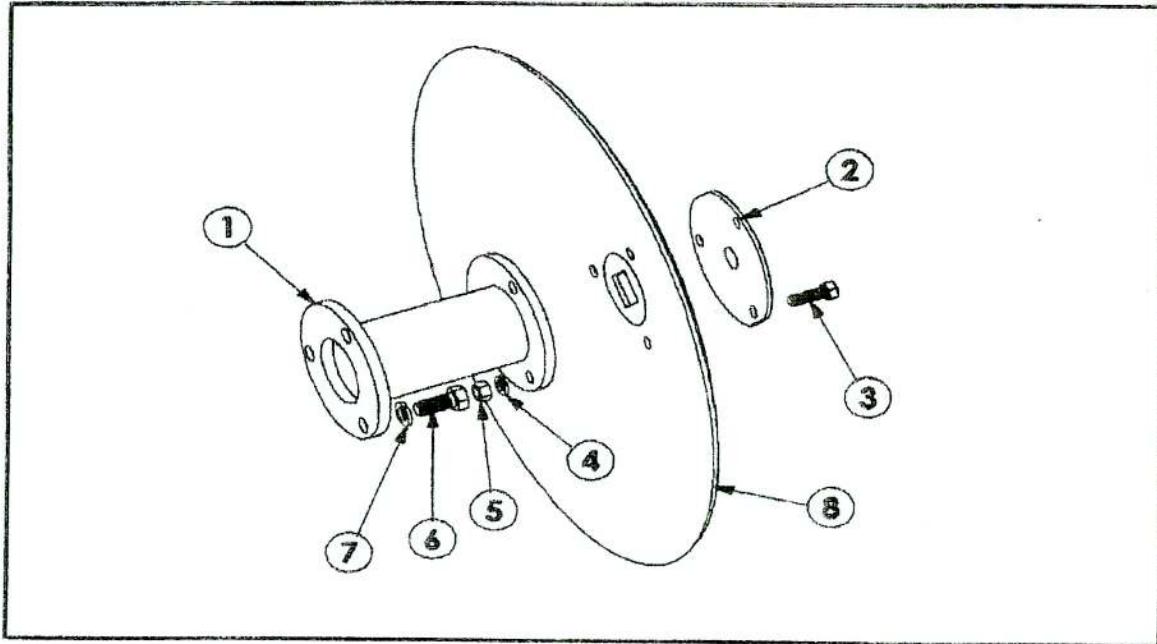

Ref#	Part#	Extension Spool Assembly	Wt./lb	List Price
1	JXE-17	Ext. Spool - (Blade Pulls In) 9"	11	
2	JXE-20	Cap-Ext. Spool, Universal, 1 1/2	3	
3	CS12112-5	Bolt-1/2ncx1 1/2lg, GR 5		
4	LW12	Lock Washer-Spring		
5	N12	Nut-1/2nc, Hex		
6	CS58112-5	Bolt-5/8ncx1 1/2lg, GR 5		
7	LW58	Lock Washer-Spring		
8	EXB-22	Ext. Blade-22"d Sld Edg, 1 1/2sq	19	
	EXB-22N	Ext. Blade-22"d Notched, 1 1/2sq	18	
	EXB-24	Ext. Blade-24"d Sld Edg, 1 1/2sq	25	
	EXB-24N	Ext. Blade-24"d Notched, 1 1/2sq	23	
	EXB-26	Ext. Blade-26"d Sld Edg, 1 1/2sq	31.5	

DOMRIES ENTERPRISES INC.

12281 Road 29

Madera, California 93638

Phone (559) 673-9143 Fax (559)673-4110

www.domrieseninc.com

MODEL-TFO

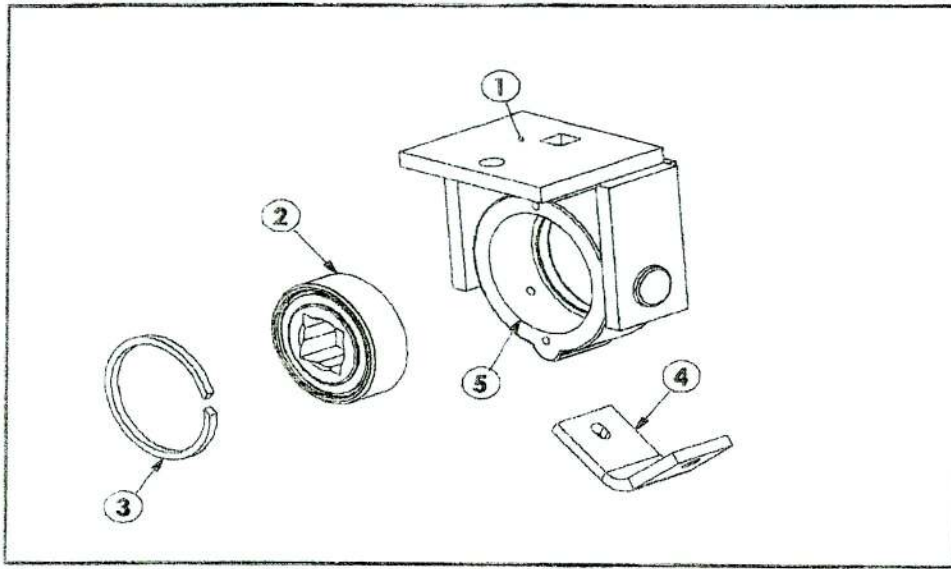

Ref#	Part#	Cleaner Bar Assembly	Wt./lb	List Price
1	X-81	Bearing Housing Weldment	12	
2	X-85	Bearing 1 1/2" SQ	2	
3	X-86	Stop Ring	0.2	
4	K 88	Wear Plate	2	
5	X-81-C	Bearing Housing casting only	5.8	

DOMRIES ENTERPRISES INC.

12281 Road 29
Madera, California 93638
Phone (559) 673-9143 Fax (559)673-4110
www.domrieseninc.com